

VICINITY MAP
SCALE: 1"=250'

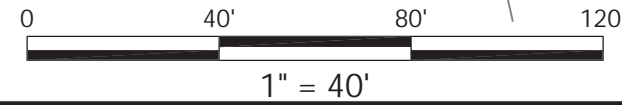

Existing Conditions
Congress Heights
Square 5914, LLC

WILES MENSCH CORPORATION

maurice walters architect

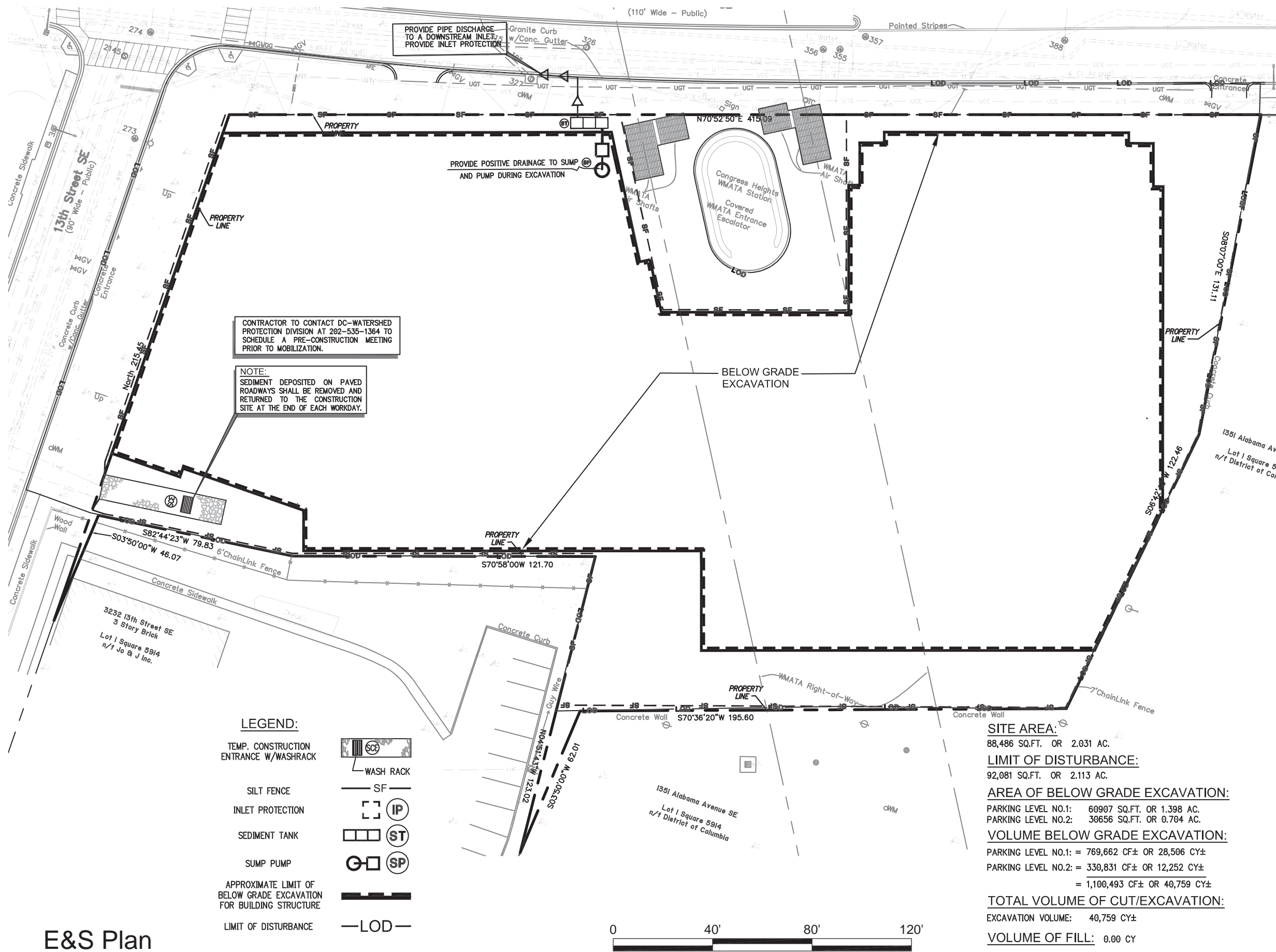

- CONSTRUCTION AND STABILIZATION SEQUENCE:**
1. INSTALL SEDIMENT AND EROSION CONTROL MEASURES INCLUDING STABILIZED CONSTRUCTION ENTRANCE, WASH RACK, INLET PROTECTION, SILT FENCE, STRAW BALE DIKE, AS INDICATED ON THIS SHEET. SEE SHEET C-501 FOR SEDIMENTATION AND EROSION CONTROL DETAILS.
 2. SEDIMENT CONTROL MEASURES SHALL BE INSPECTED AND APPROVED BY THE INSPECTOR PRIOR TO COMMENCING ANY OTHER LAND DISTURBING ACTIVITIES.
 3. REMOVE ITEMS AS INDICATED ON DEMOLITION PLAN.
 4. INSTALL SITE IMPROVEMENTS AS INDICATED ON CONSTRUCTION DOCUMENTS FOR THE PROPOSED BUILDING.
 5. AT THE COMPLETION OF CONSTRUCTION AND AFTER THE INSPECTOR'S APPROVAL, ALL TEMPORARY SALUTATION, SEDIMENTATION AND EROSION CONTROL MEASURES SHALL BE REMOVED.

- DUST CONTROL NOTES:**
1. THE CONTRACTOR SHALL CONDUCT OPERATIONS AND MAINTAIN THE PROJECT SITE AS TO MINIMIZE THE CREATION AND DISPERSION OF DUST. DUST CONTROL SHALL BE USED THROUGHOUT THE WORK AT THE SITE.
 2. THE CONTRACTOR MUST PROVIDE CLEAN WATER, FREE FROM SALT, OIL AND OTHER DELETERIOUS MATERIAL TO BE USED FOR ON-SITE DUST CONTROL.
 3. THE CONTRACTOR SHALL SUPPLY WATER SPRAYING EQUIPMENT CAPABLE OF ACCESSING ALL WORK AREAS.
 4. THE CONTRACTOR SHALL IMPLEMENT STRICT DUST CONTROL MEASURES DURING ACTIVE CONSTRUCTION PERIODS ON-SITE. THESE CONTROL MEASURES WILL GENERALLY CONSIST OF WATER APPLICATIONS THAT SHALL BE APPLIED A MINIMUM OF ONCE PER DAY DURING DRY WEATHER OR MORE OFTEN AS REQUIRED TO PREVENT DUST EMISSIONS.
 5. FOR WATER APPLICATION TO UNDISTURBED SOIL SURFACES, THE CONTRACTOR SHALL:
 - A. APPLY WATER WITH EQUIPMENT CONSISTING OF TANK, SPRAY BAR, PUMP WITH DISCHARGE PRESSURE GAUGE;
 - B. ARRANGE SPRAY BAR HEIGHT, NOZZLE SPACING AND SPRAY PATTERN TO PROVIDE COMPLETE COVERAGE OF GROUND WITH WATER;
 - C. DISPERSE WATER THROUGH NOZZLES ON SPRAY BAR AT 20 PSI (137.8 K PA) MINIMUM KEEP AREAS DAMP WITHOUT CREATING NUISANCE CONDITIONS SUCH AS PONDING
 6. FOR WATER APPLICATION TO SOIL SURFACES DURING DEMOLITION AND/OR EXCAVATION, THE CONTRACTOR SHALL:
 - A. APPLY WATER WITH EQUIPMENT CONSISTING OF A TANK, PUMP WITH DISCHARGE GAUGE, HOSES AND MIST NOZZLES;
 - B. LOCATE TANK AND SPRAYING EQUIPMENT SO THAT THE ENTIRE EXCAVATION AREA CAN BE MISTED WITHOUT INTERFERING WITH DEMOLITION AND/OR EXCAVATION EQUIPMENT OF OPERATIONS. KEEP AREAS DAMP WITHOUT CREATING NUISANCE CONDITIONS SUCH AS PONDING.
 - C. APPLY WATER SPRAY IN A MANNER TO PREVENT MOVEMENT OF SPRAY BEYOND SITE BOUNDARIES.

- EROSION AND SEDIMENTATION CONTROL NOTE:**
1. THE CONTRACTOR SHALL BE RESPONSIBLE FOR DESIGN OF SHEETING AND SHORING AN SUPPORT OF EXISTING UTILITIES AND ADJACENT STRUCTURES. SHORING, BRACING, AN UNDERPINNING DESIGNED BY THE CONTRACTOR'S STRUCTURAL ENGINEER LICENSED IN T-DISTRICT OF COLUMBIA SHALL BE PROVIDED AS NECESSARY TO ENSURE THEIR SUPPORT
 2. PROVIDE SILT FENCE AT PERIMETER OF EXCAVATION AREA TO REMAIN IN PLACE UNT BELOW GRADE EXCAVATION HAS BEGUN UNLESS OTHERWISE APPROVED BY T-INSPECTOR.
 3. PROVIDE CONSTRUCTION FENCE AT PERIMETER OF EXCAVATION AREA TO REMAIN I PLACE UNLESS OTHERWISE APPROVED BY THE INSPECTOR.
 4. CONTRACTOR TO PROVIDE ON SITE APPROVED STAMPED AND SIGNED SEDIMENTATION AN EROSION CONTROL DRAWINGS BY DEPARTMENT OF THE ENVIRONMENT, WATERSHE PROTECTION DIVISION.
 5. THE APPLICANT MUST NOTIFY THE DEPARTMENT OF ENVIRONMENT BY PHON (202-535-2240) AT LEAST 24 HOURS PRIOR TO THE START OF GRADING ACTIVITY AN WITHIN (2) WEEKS AFTER COMPLETION OF PROJECT TO REQUEST INSPECTION. IF THERE I NEED TO MAKE CHANGES OR MODIFICATIONS IN THE APPROVED DESIGN, DEPARTMENT C ENVIRONMENT MUST BE NOTIFIED IMMEDIATELY.

THIS SHEET IS FOR
EROSION AND SEDIMENTATION
CONTROL PURPOSES ONLY!!!

LEGEND:

- TEMP. CONSTRUCTION ENTRANCE W/WASHRACK
- WASH RACK
- SILT FENCE
- INLET PROTECTION
- SEDIMENT TANK
- SUMP PUMP
- APPROXIMATE LIMIT OF BELOW GRADE EXCAVATION FOR BUILDING STRUCTURE
- LIMIT OF DISTURBANCE

SITE AREA:
88,486 SQ.FT. OR 2.031 AC.

LIMIT OF DISTURBANCE:
92,081 SQ.FT. OR 2.113 AC.

AREA OF BELOW GRADE EXCAVATION:
PARKING LEVEL NO.1: 60907 SQ.FT. OR 1.398 AC.
PARKING LEVEL NO.2: 30656 SQ.FT. OR 0.704 AC.

VOLUME BELOW GRADE EXCAVATION:
PARKING LEVEL NO.1: = 769,662 CF± OR 28,506 CY±
PARKING LEVEL NO.2: = 330,831 CF± OR 12,252 CY±
= 1,100,493 CF± OR 40,759 CY±

TOTAL VOLUME OF CUT/EXCAVATION:
EXCAVATION VOLUME: 40,759 CY±

VOLUME OF FILL: 0.00 CY

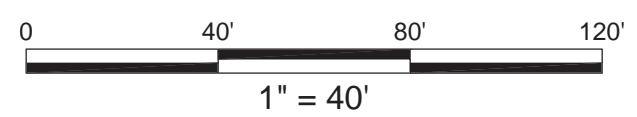

E&S Plan
Congress Heights
Square 5914, LLC



maurice walters architect